

## Video System

### Video System Component Location

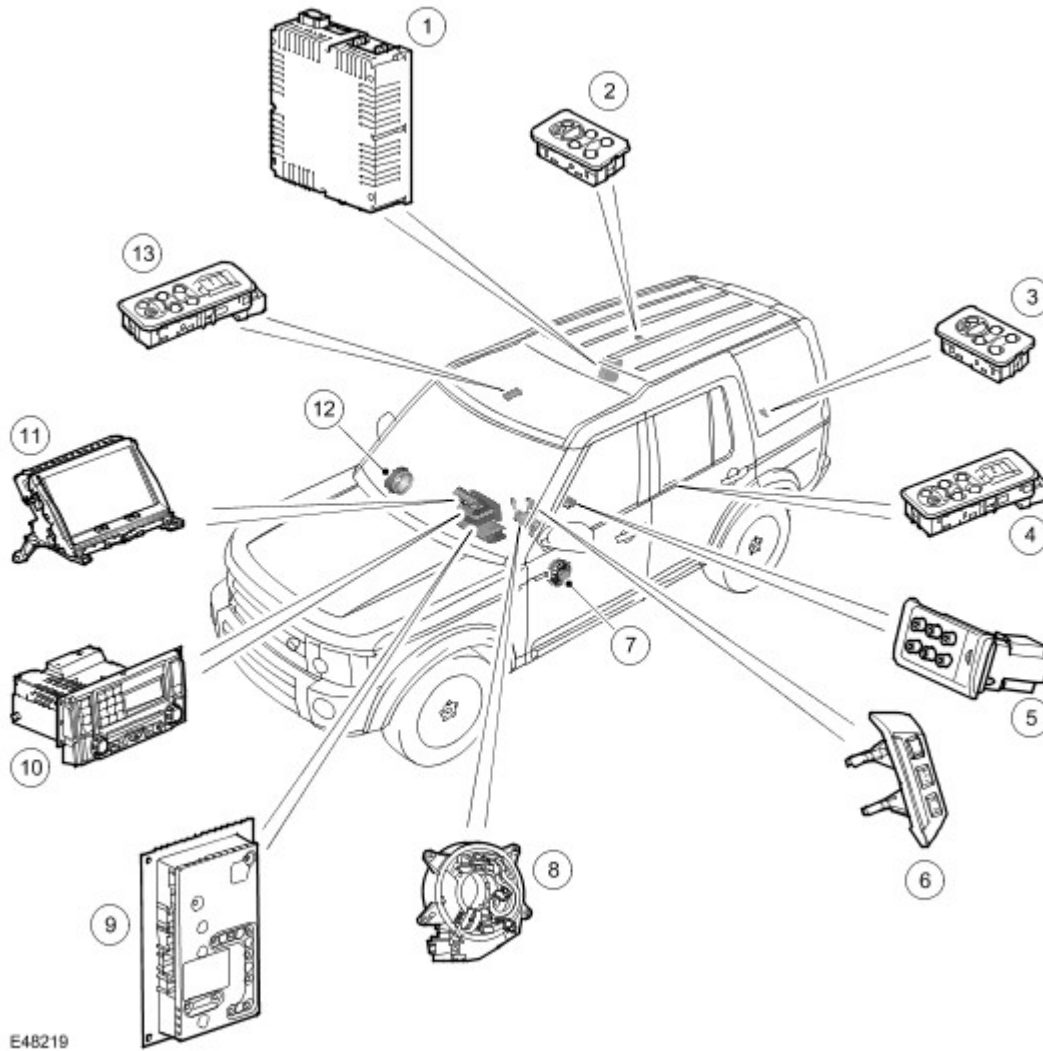

E48219

Item	Part Number	Description
1	-	Rear Seat Entertainment (RSE) screen (for future release)
2	-	Television tuner module
3	-	RH row three remote audio controls
4	-	Rear seat entertainment control module (for future release)
5	-	DVD autochanger (for future release)
6	-	LH row three remote audio controls
7	-	LH row two remote audio controls
8	-	Audio/Video input/output panel (for future release)
9	-	Steering wheel controls
10	-	Speaker
11	-	Clock spring

12	-	Audio amplifier
13	-	IHU
14	-	Touch screen display (TSD)
15	-	Speakers
16	-	RH row two remote audio controls

### Video System Component Location

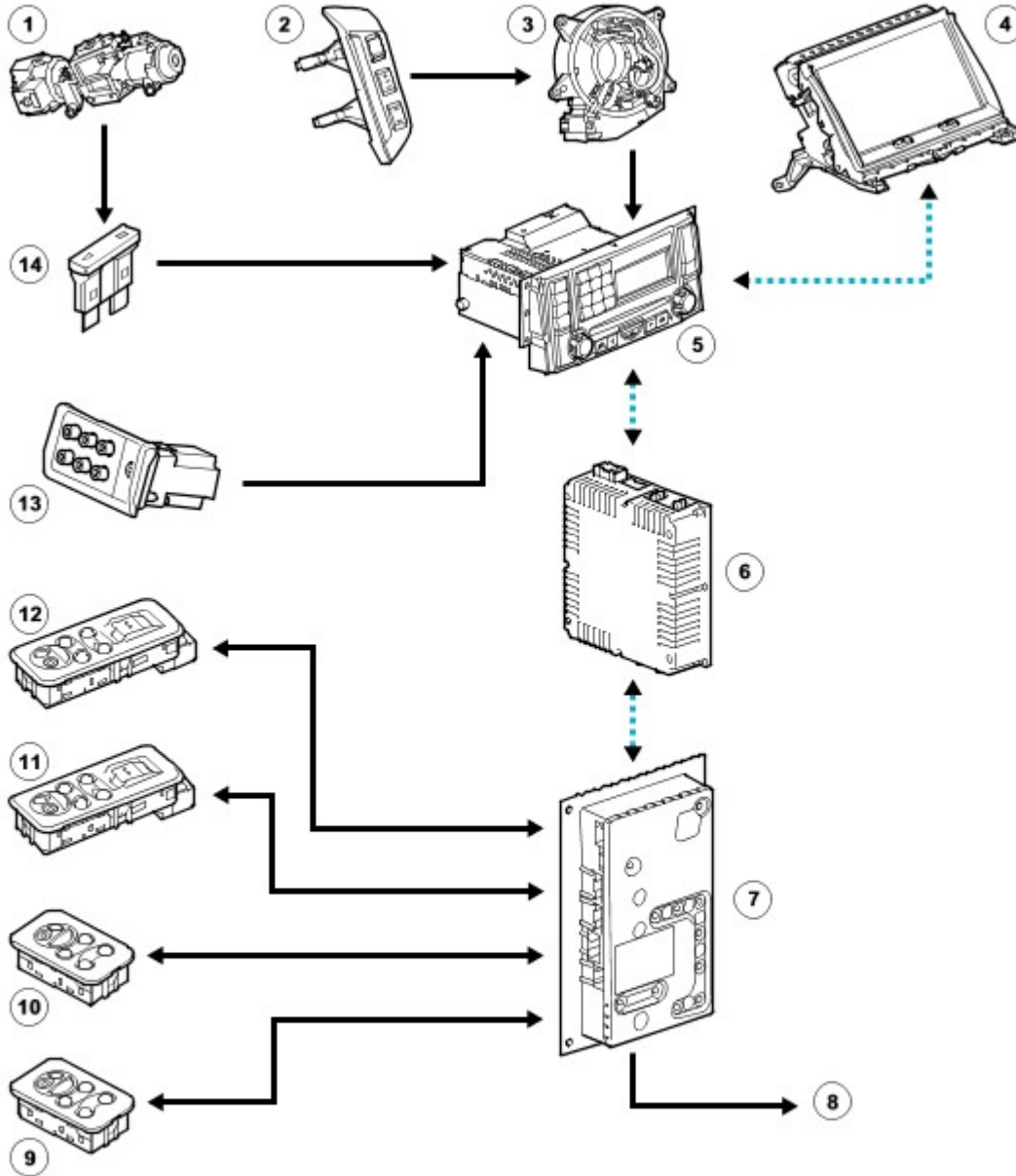

E48220



Item	Part Number	Description
1	-	Ignition Switch
2	-	Steering wheel controls

3	-	Clock spring
4	-	Integrated head unit (IHU)
5	-	Touch screen display (TSD)
6	-	Rear Seat Entertainment Control Module (for future release)
7	-	Rear seat entertainment screen (for future release)
8	-	IR remote control (for future release)
9	-	Television tuner
10	-	DVD autochanger (for future release)
11	-	Speakers
12	-	Amplifier
13	-	Rear door remote audio controls/headphone socket
14	-	Rear door remote audio controls/headphone socket
15	-	Rear door remote audio controls/headphone socket and window switch
16	-	Rear door remote audio controls/headphone socket and window switch
17	-	AV input panel (for future release)
18	-	Fuse

The Video system comprises:

- Front screen (Navigation Touch screen Display TSD)
- Television tuner module
- Television antennas
- Rear remote control headphone modules

The Rear Seat Entertainment System (RSE) will be available at a later dates and comprises:

- RSE control module
- RSE IR remote control
- RSE roof mounted screen
- DVD multi changer
- AV input panel

The rear multimedia system provides video and audio entertainment for the rear seat occupants. The system allows rear seat occupants to:

- Play video Digital Versatile Discs (DVDs), video Compact Discs (CDs) and audio CDs stored in the DVD player.
- View the Television (TV) output selected on the Touch Screen Display (TSD) unit (with the vehicle moving up to 5 kph).

The video and TV pictures are viewed on Liquid Crystal Display (LCD) Roof mounted screen. The audio output can be played through headphones or over the vehicle audio system speakers.

## TELEVISION

The television system receives television signals from television antennas in the rear side screens. The antennas are connected to the television tuner via coaxial leads. For additional information, refer to [Antenna](#) (415-02 Antenna)

## Television Tuner

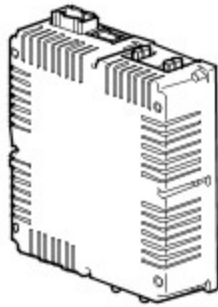

E48221

The television tuner module is located in the rear RH side of the luggage compartment. The television tuner is connected to the rest of the video system on the MOST bus. Audio and control signals are passed on the MOST bus while video is transmitted via a coaxial cable to the Touch Screen Display (TSD). For additional information, refer to [Communications Network](#) (418-00 Module Communications Network)

Television audio can be heard through the vehicle speakers and the remote control rear headphone modules. The audio will continue to be heard whilst the vehicle is moving, however the television picture will stop displaying once the vehicle starts moving.

### Television Tuner Module Pinout Table C2117

Pin No	Description	Input/Output
1	NC	
2	NC	
3	NC	
4	Video signal	Input
5		-
6	NC	-
7	NC	-
8	NC	-
9	Video signal	Output
10	Video ground	-
11	Video ground	-
12	NC	-
13	Power	Input

### REMOTE AUDIO CONTROLS

#### Third Row Remote Audio Controls



E48224

The second and third row seat passenger can use standard headphones to listen to audio from any of the sources fitted to the vehicle. These include:

- Television
- CD
- Radio
- DVD

There are four remote audio control modules, two in the rear doors incorporating the rear window switches and two in the rear load space each side of the third row seats.

The remote audio control modules allow the user to select which source to listen to. The remote controls cannot override what the driver has selected to listen to. If the driver is listening to a CD the rear passenger cannot control the CD player.

The remote audio control modules allow the user to alter the volume in the head phones, change track/disc up/down or repeat on a CD, change pre-set radio stations or tune up/down on the radio and television.

## DVD AUTOCHANGER



E48223

The DVD autochanger is installed in the RH side of the luggage compartment, behind the trim panel. Up to six discs can be stored in the DVD autochanger, in a removable magazine. The magazine is installed behind a sliding door in the front face of the DVD autochanger. The magazine is removed from the DVD autochanger by pressing an eject button, which is visible once the sliding door is open. Any combination of video DVDs, video CDs and audio CDs can be loaded in the magazine.

## ROOF MOUNTED SCREEN



The roof mounted screen is centrally located in the headlining between rows one and two. The screen has a resolution of 800 x 600. The rear screen displays in 16:9 wide-screen format

The roof mounted screen houses an infrared sensor. The infrared sensor receives the signals output by the remote control and routes them via the MOST BUS to the RSE control module.

An ambient light sensor, in the bottom left edge of the screen, allows the system to automatically adjust the brightness of the screen to compensate for changes in ambient light levels.

## REMOTE CONTROL



The remote control is an IR type and can be used to control playback of the discs stored in the DVD autochanger.