

## Steering Angle Sensor (57.40.02)

### Removal

1. Disconnect the battery ground cable. For additional information, refer to [Specifications](#) (Section 414-00)
2. Remove the driver side closing trim panel.
  - ▶ Release the clip.
  - ▶ Remove the 2 screws.
  - ▶ Disconnect the electrical connector.

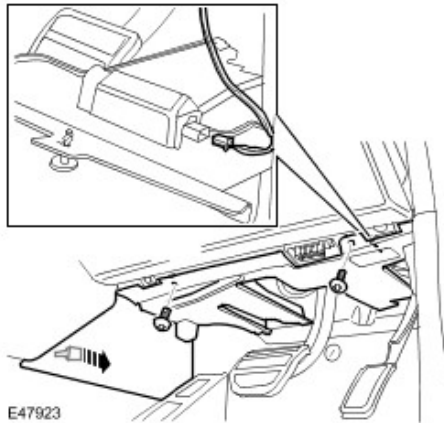

3. Disconnect the steering angle sensor electrical connector.



4. Disconnect the steering column intermediate shaft from the steering column.
  - ▶ Note the fitted position.
  - ▶ Remove the special bolt and discard the nut.



5. Remove the steering angle sensor.
  - ▶ Remove the 3 Torx screws.

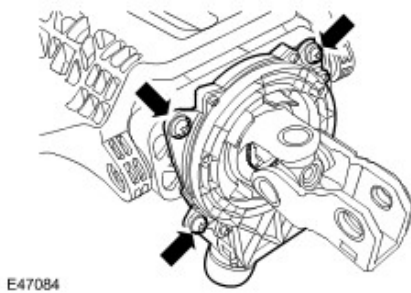

## Installation

1. Install the steering angle sensor.
  - ▶ Tighten the Torx screws to 3 Nm (2 lb.ft).
2. Connect the steering column intermediate shaft.
  - ▶ Install the special bolt and tighten the new nut to 22 Nm (16 lb.ft).
3. Connect the steering angle sensor electrical connector.
4. Install the closing trim panel.
  - ▶ Connect the electrical connector.
  - ▶ Secure the clip.
  - ▶ Tighten the screws.
5. Connect the battery ground cable. For additional information, refer to [Specifications](#) (Section 414-00)
6. Initiate a new steering angle sensor using T4.